



Battery Lift Magnets

All The Convenience Of An Electro With No Outside Power Source



MG-02E

Battery Lift Magnets (BLM) operate on a self-contained automotive type battery, which results in maximum convenience, portability, versatility, and dependability. No need for external power cords. Ideal for remote locations, use with forklift type transports, or lift cranes that do not have means of power. BLM's come complete with built-in chargers and a visible power gauge that shows when the magnet needs charging. This simple lift magnet does not have fancy lights, whistles or bells that can malfunction and cause a dangerous lifting situation. BLM's make loading and unloading of thick, non-flexing ferrous parts simple and fast.

WARNING: BLM's are not intended to be used as scrap handling magnets. Picking up several pieces of steel at once is not recommended and may result in serious injury or property damage. You must have 100% coverage on a FLAT SURFACE to operate the magnet.

NOTES:

- Never stand under load being lifted.
- Always use extra caution.
- Only use magnetic lifts on material that does not flex or bend.
- The surface of the lift and the load must be clean & free of chips, oil, slag, dirt, etc.
- Lifts must be centered on the load.
- These lift magnets are Not recommended for painted or finish coated surfaces.



***BATTERIES NOT INCLUDED**

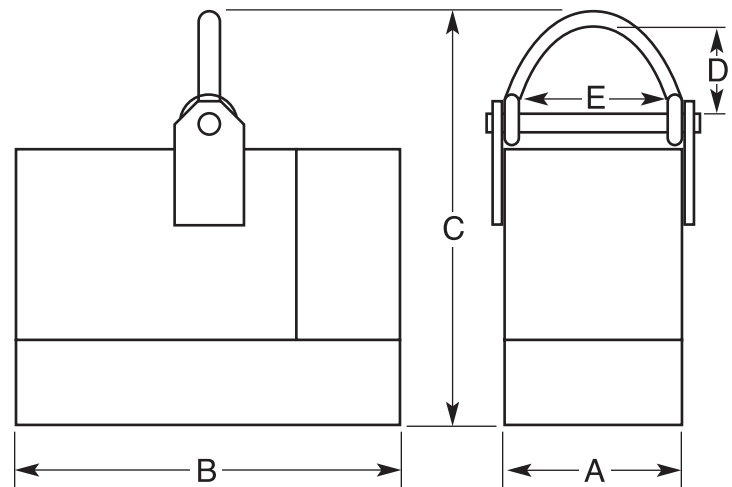

Part No.	Working Load Limit (lbs.)	Battery Required (Deep Cycle 12V)	Watts	Width A	Length B	Height C	Bail Ht. (D)	Bail Wd. (E)	Weight w/ Battery (lbs.)
BLM2000	2,000	U1 - DC	64	8-3/4"	8-3/4"	12-3/4"	2-7/16"	4"	77
BLM3000	3,000	22NF - HC	76	9-1/2"	11-1/2"	18-1/2"	4-1/4"	5"	135
BLM5000	5,000	27DC or 27DCM	80	8"	16-3/4"	19-1/4"	4-1/4"	5"	225
BLM11000	11,000	27DC or 27DCM	160	10-1/4"	48"	22-9/16"	4-3/4"	6"	500
BLM11500	11,000	27DC or 27DCM	160	17-3/4"	30"	22-1/8"	4-3/4"	6"	500

Key Markets

Fabrication, Machine Tool, Foundries, Steel Service Center, Machine Builders

Related Products

PowerLifts®, Creative Lifts®, Sheet Handlers, Battery Lifts, Electromagnets, Floor Sweepers, Pick-Up Tools, Welding Squares & Grounds

All Photos And Drawings Represent The Products At The Time Of Publication (09/15)

Industrial Magnetics, Inc. • 1385 South M-75 • Boyne City, MI 49712 • p: 888.582.0822 • f: 231.582.2704 • w: www.magnetics.com • e: imi@magnetics.com